



PNEUMATIC COUPLINGS
PNEUMATISCHE KUPPLUNGEN

SERIE 112-19



Materials

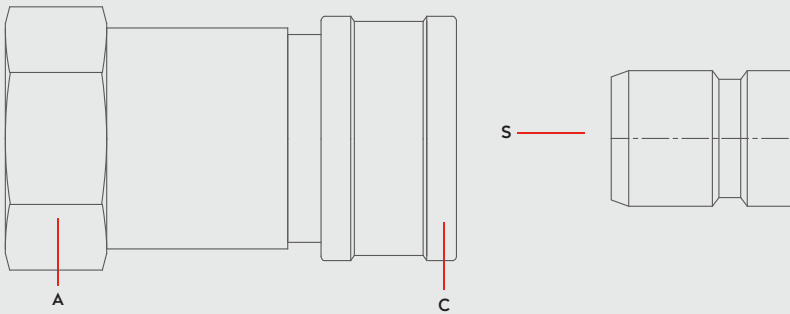

Material Code

A = Brass Nickel Plated

C = Brass Nickel Plated

S = Brass Nickel Plated



0 - 10 bar



-40° to + 105°C (NBR)



112.12
OM 262 - 01510
OM 200 - 00800 (valved)
112.19
OM 353 - 02340
OM200 - 03000 (valved)

Shut Off Type



Options

NICKEL

AISI316
Stainless Steel

Plug Profile Serie 112

112.12

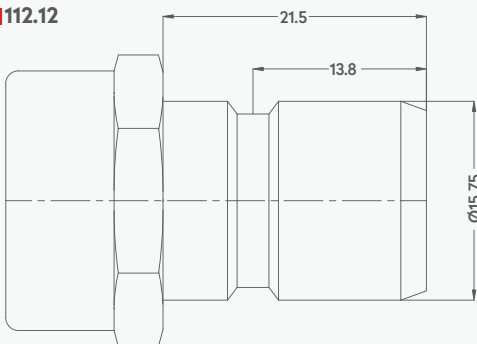

112.19

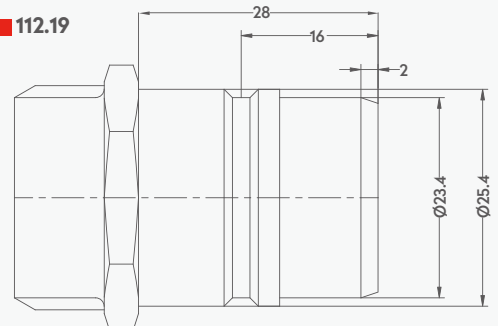

Air 6 Bar

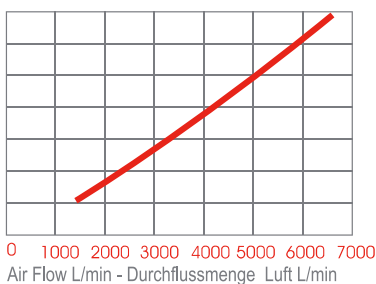

Water

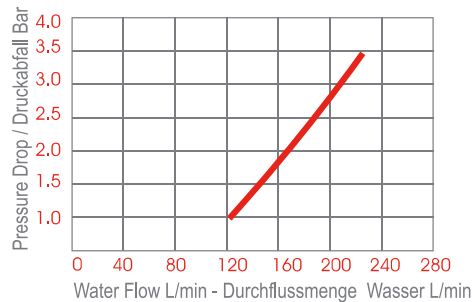

Compatible with

PARKER - LEGRIS Ø12 - Ø19

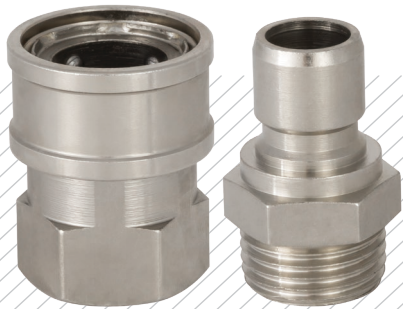

VALVED QUICK COUPLINGS SCHNELLKUPPLUNGEN MIT VENTIL

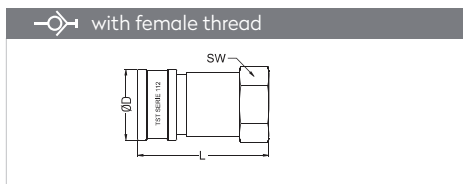

Connection	Part No.	SW	L	ØD
BSP 3/8"	112.12 DG 17	27	55.5	28.8
BSP 1/2"	112.12 DG 21	27	55.5	28.8

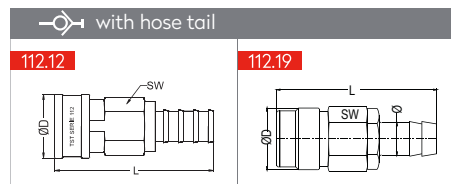

Connection	Part No.	SW	L	ØD
Ø 13	112.12 HG 13	27	87.7	28.8
Ø 15	112.12 HG 15	27	87.7	28.8
Ø 19	112.12 HG 19	27	93.3	28.8
Ø 19	112.19 HG 19	36	90.5	39.6

UNVALVED QUICK COUPLINGS SCHNELLKUPPLUNGEN OHNE VENTIL

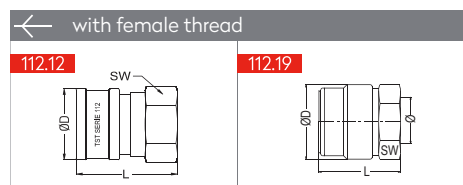

Connection	Part No.	SW	L	ØD
BSP 3/8"	112.12 DGF 17	24	34	28.8
BSP 1/2"	112.12 DGF 21	24	34	28.8
BSP 3/4"	112.12 DGF 26	30	38	28.8
BSP 1"	112.12 DGF 33	36	40	28.8
BSP 1"	112.19 DGF 33	36	45	39.6

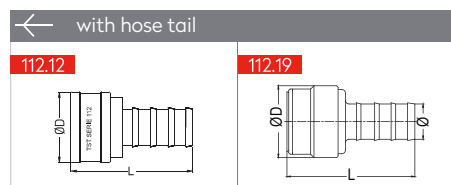

Connection	Part No.	L	ØD
Ø 12	112.12 HGF 12	51	28.8
Ø 15	112.12 HGF 15	51	28.8
Ø 19	112.12 HGF 19	57	28.8
Ø 19	112.19 HGF 19	70	39.6
Ø 25	112.19 HGF 25	70	39.6

PLUGS STECKNIPPEL

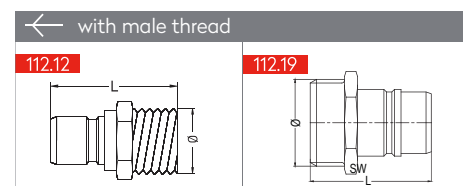

Connection	Part No.	SW	L
BSP 3/8"	112.12 EU 17	22	31.5
BSP 1/2"	112.12 EU 21	22	37
BSP 3/4"	112.12 EU 26	27	41
BSP 1"	112.12 EU 33	35	41
BSP 3/4"	112.19 EU 26	27	42.5
BSP 1"	112.19 EU 33	35	46

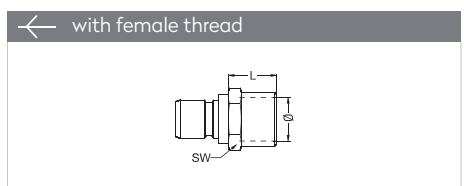

Connection	Part No.	SW	L
BSP 1/4"	112.12 DU 13	17	37.5
BSP 3/8"	112.12 DU 17	21	37.5
BSP 1/2"	112.12 DU 21	25	37.5
BSP 3/4"	112.12 DU 26	32	42.5
BSP 1"	112.12 DU 33	38	45.5

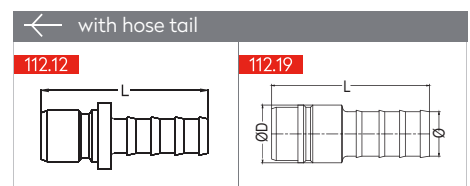

Connection	Part No.	L	ØD
Ø 7	112.12 HU 07	54	17
Ø 10	112.12 HU 10	54	17
Ø 12	112.12 HU 12	50	17
Ø 13	112.12 HU 13	54	17
Ø 15	112.12 HU 15	50	18
Ø 16	112.12 HU 16	50	20
Ø 19	112.12 HU 19	57.5	21
Ø 19	112.19 HU 19	69	25.3
Ø 25	112.19 HU 25	69	25.3

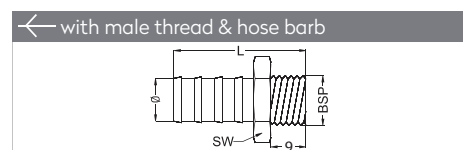

Connection	Part No.	SW	L
Ø 12 - BSP 1/2"	112.12 GU 12	22	41.2
Ø 13 - BSP 1/2"	112.12 GU 13	22	41.2
Ø 15 - BSP 1/2"	112.12 GU 15	22	41.2
Ø 19 - BSP 1/2"	112.12 GU 19	22	46.8
Ø 21 - BSP 1 1/2"	112.12 GU 21	24	46.8

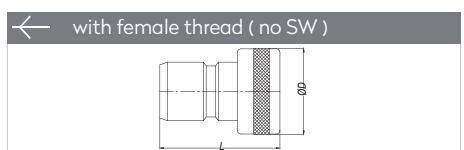

Connection	Part No.	L	ØD
BSP 3/8"	112.12 DN 17	32	20
BSP 1/2"	112.12 DN 21	35	24
BSP 3/4"	112.12 DN 26	39	32
BSP 1"	112.12 DN 33	44	39